



# INSTRUCTION BULLETIN

No. 9004969  
Machine: S30/S30 X4/  
S30 XP  
Published: 12-2008  
Rev. 00

**NOTE: DO NOT DISCARD the Parts List from the Instruction Bulletin. Place the Parts List in the appropriate place in the machine manual for future reference. Retaining the Parts List will make it easier to reorder individual parts and will save the cost of ordering an entire kit.**

*NOTE: Numbers in parenthesis ( ) are reference numbers for parts listed in Bill of Materials.*

Installation instructions for **kit number 9004975**

## **SYNOPSIS:**

This kit contains the parts needed to replace a door latch on S30, S30 XP, and S30 X4 machines equipped with an optional cab.

Please follow step-by-step instructions.

## **SPECIAL TOOLS / CONSIDERATIONS: NONE**

(Estimated time to complete: 45 minutes)

---

### **PREPARATION:**

1. Park the machine on a clean level surface, turn off the machine, remove the key, and set the parking brake.

**FOR SAFETY: Before leaving or servicing machine, stop on level surface, turn off machine, and remove key.**

2. Open the door and remove the latch cover and existing door latch assembly and handle from the door. Set the the latch cover and all hardware aside. Discard the removed door latch assembly and handle.

### **INSTALLATION:**

1. If necessary, cut or grind two 3/16" deep notches into the door handle recess. No cutting or grinding is necessary if notches are already cut into the door handle recess. Refer to Fig. 1 for locations and dimensions.
2. Install the new door latch assembly (1) onto the door. Refer to Fig. 1.
3. Open and close the door several times to ensure the handle and latch operate.
4. Use the key (2) to lock the door and then attempt to open the door. The door should not open when locked. Unlock the door and open the door. The door should open when unlocked.

**Do Not** disassemble the door latch assembly. Door latch assembly is shown disassembled to better show part locations on door.

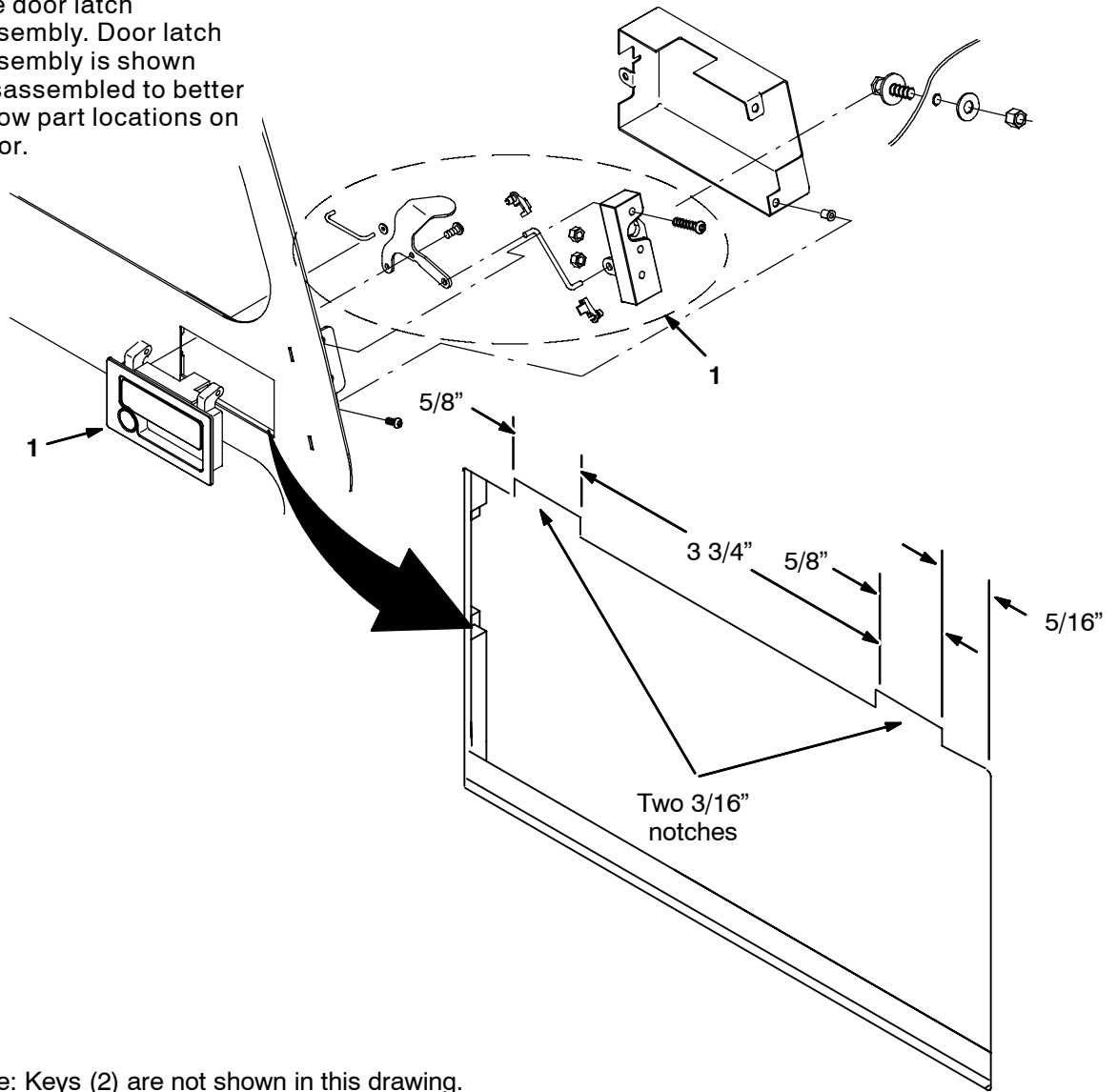

Note: Keys (2) are not shown in this drawing.

FIG. 1

Bill of Materials for Latch Kit, Door, Replmt [S30] - 9004975

Ref.	Tennant Part No.	Description	Qty.
▽	9004975	Latch Kit, Door, Replmt [S30]	1
▲ 1	9004973	VR, Handle, Locking, Cab	1
▲ 2	9004971	VR, Key, Latch, Door Assy	2

TENNANT COMPANY  
P. O. Box 1452  
Minneapolis, MN 55440-1452